

Features

- Ports: 8 10/100TX
- Type of Switch: Unmanaged
- Switch Fabric: 1.6Gbps
- Power Consumption: 2.1W / 7.1BTU
- Throughput: 1.19Mpps
- Operating Temperature: -40 to 75°C
- IEEE 802.3 10BASE-T, IEEE 802.3u 100BASE-TX standard

Specifications

Hardware	
10/100BASE-TX Auto MDI/MDIX Ports	8 ports
LED Indicators	3 x LED for System and Power ■ Green: DC Power 1 ■ Green: DC Power 2 ■ Green: Power Fault 1x LED for each Copper Port ■ Green: 10/100 LNK/ACT
Enclosure	IP30-rated metal case
Dimensions (WxDxH)	135 x 87 x 32 mm
Weight	428g
ESD Protection	6KV DC
EFT Protection	6KV DC
Power Requirements	12~48V DC, redundant power with polarity reverse protection function, 24V AC power support
Power Consumption/Dissipation	2.1 watts/7.1BTU
Installation	DIN rail kit and wall-mount ear
Alarm	Provides one relay output for power failure Alarm relay current carry ability: 3A@DC 30V
Connector	Removable 6-pin terminal block Pin 1/2 for Power 1; Pin 3/4 for fault alarm; Pin 5/6 for Power 2

Switch Specifications	
Switch Processing Scheme	Store-and-Forward
Address Table	1K
Buffer Memory	Embedded 448K bits packet buffer
Flow Control	Back pressure for half duplex, IEEE 802.3x pause frame for full duplex
Switch Fabric	1.6Gbps
Throughput (packet per second)	1.19Mpps
Network Cables	10BASE-T: 2-pair UTP Cat. 3, 4, 5, up to 100 meters 100BASE-TX: 2-pair UTP Cat. 5, 5e up to 100 meters

Dimensions

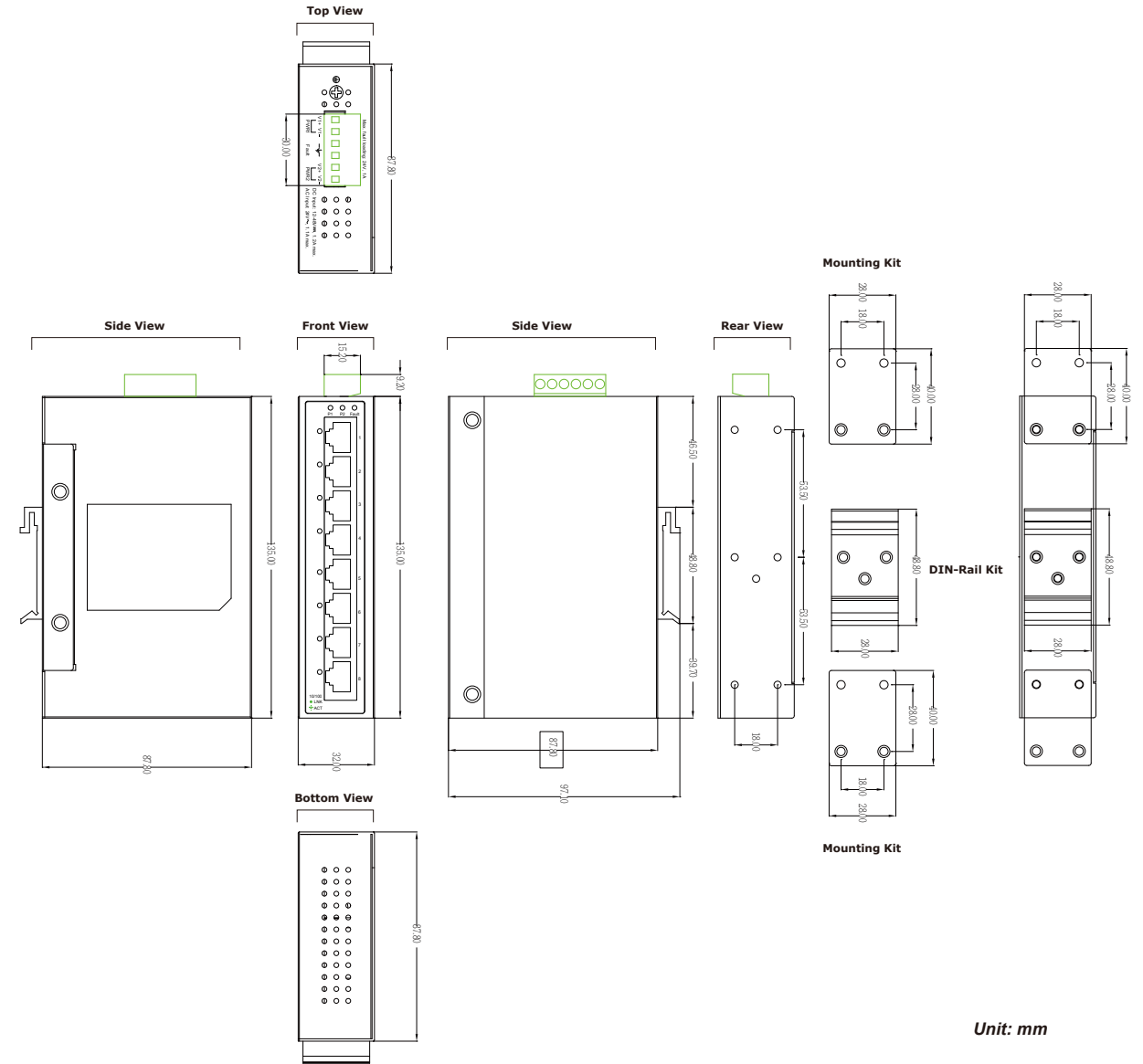

Unit: mm

Standards Conformance	
Standards Compliance	IEEE 802.3 Ethernet IEEE 802.3u Fast Ethernet IEEE 802.3x Full Duplex Flow Control IEEE 802.3az Energy Efficient Ethernet
Regulatory Compliance	FCC Part 15 Class A, CE
Stability Testing	IEC60068-2-32 (free fall) IEC60068-2-27 (shock-proof) IEC60068-2-6 (vibration-proof)
Temperature	-40~75 °C
Humidity	5 to 95%, non-condensing



Singel 3 | B-2550 Kontich | Belgium | Tel. +32 (0)3 458 30 33
 info@alcom.be | www.alcom.be
 Rivium 1e straat 52 | 2909 LE Capelle aan den IJssel | The Netherlands
 Tel. +31 (0)10 288 25 00 | info@alcom.nl | www.alcom.nl